

# LINE 100-120-125-127 VALVES FOR PANEL MOUNTING ACTUATORS

**FLUIDTECHNIK**  
bohemia



## GENERAL FEATURES

	line 100	line 120 125 127
<b>Construction</b>	poppet type	spool
<b>Body material</b>	technopolymer	technopolymer / aluminium
<b>Single use</b>	yes	yes
<b>Combined use</b>	yes	no
<b>Available functions</b>	2/2 - 3/2	3/2 - 5/2
<b>Installation</b>	through-wall panel actuator	

## POSSIBLE COMBINATIONS EXAMPLE



## GENERAL TECHNICAL DATA

	line 100	line 120 125 127
<b>Fluid</b>	air	air
<b>Connections</b>	M5 - AU4	1/8 - 1/4
<b>Temperature Range</b>	-5 / +50°C (23 / 122°F) Please note: Below 3°C the air of the circuit must be free from humidity	
<b>Working Pressure</b>	2 - 10 bar	1 - 10 bar
<b>Reference Pressure</b>	75 l/min	670; 800; 800 l/min

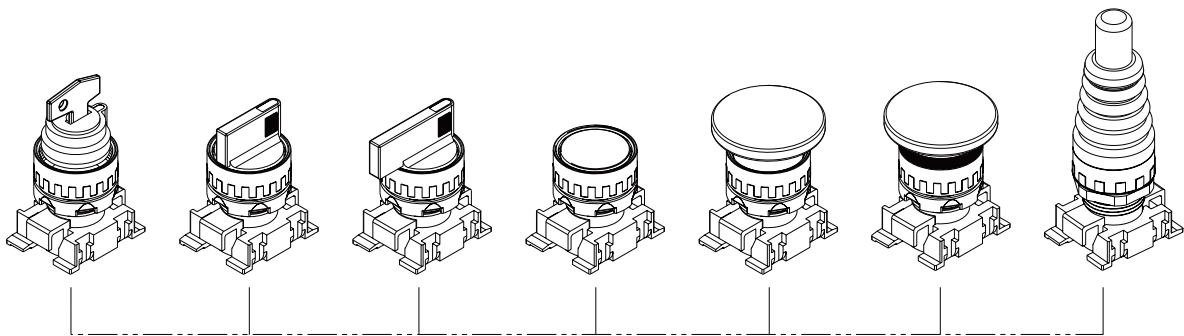

## DRILLING MEASURES

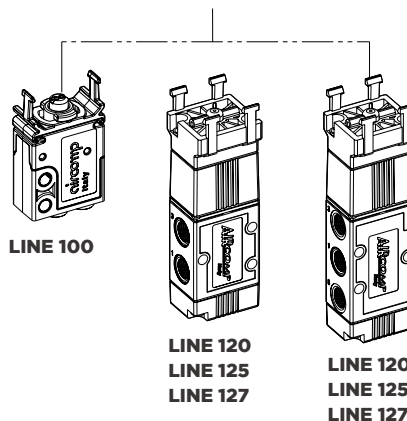
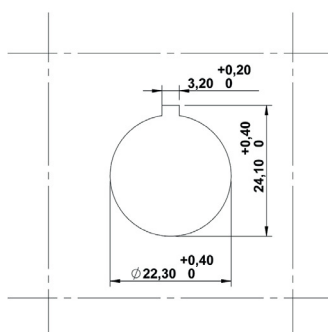

# LINE 100-120-125-127 | PANEL ACTUATORS

**FLUIDTECHNIK**  
bohemia

## PROTECTED PUSH BUTTON

Technopolymer body, round front element

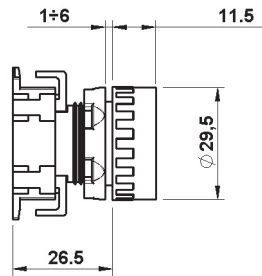

COLOR	CODE	REF.
RED	1003A00074	RT010 PULSANTE + COVER
BLACK	1003A00075	RT010 PULSANTE + COVER
YELLOW	1003A00076	RT010 PULSANTE + COVER
GREEN	1003A00077	RT010 PULSANTE + COVER
WHITE	1003A00078	RT010 PULSANTE + COVER
BLUE	1003A00079	RT010 PULSANTE + COVER

## 2 - 3 POSITIONS SHORT LEVER SELECTOR

Technopolymer body, round front element.

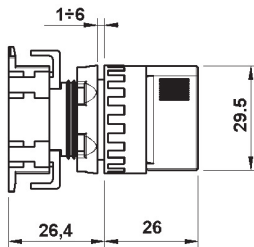

POSITION	CODE	REF.
	1003A00032	RT300N SELECTOR (2 FIXED POSITIONS)
	1003A00033	RT350N SELECTOR (2 RETURN POSITION)
	1003A00034	RT313N SELECTOR (3 FIXED POSITIONS)
	1003A00035	RT383N SELECTOR (3 RETURN TO CENTRE POSITION)

## 2 - 3 POSITIONS LONG LEVER SELECTOR

Technopolymer body, round front element.

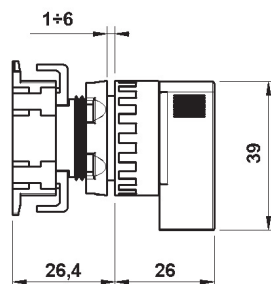

POSITION	CODE	REF.
	1003A00036	RT400N SELECTOR (2 FIXED POSITIONS)
	1003A00037	RT450N SELECTOR (2 RETURN POSITION)
	1003A00038	RT413N SELECTOR ( 3 FIXED POSITIONS)
	1003A00039	RT483N SELECTOR (3 RETURN TO CENTRE POSITION)

## 2 POSITIONS KEY SELECTOR

Technopolymer body, round front element

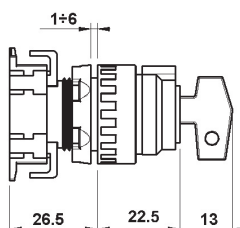

POSITION	CODE	REF.
	1003A00031	RT201N SELECTOR (2 FIXED POSITIONS)

AIR PREPARATION

VALVES

CYLINDERS

FITTINGS

WATER PREPARATION

# LINE 100-120-125-127 | PANEL ACTUATORS

**FLUIDTECHNIK**  
bohemia

## AXIAL MUSHROOM

Technopolymer body, round front element.

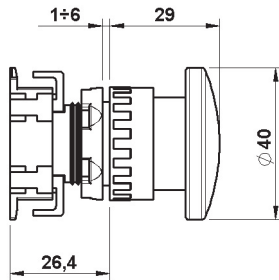

COLOR	CODE	REF.
RED	1003A00041	RT050R MUSHROOM
BLACK	1003A00042	RT050N MUSHROOM

## AXIAL MUSHROOM WITH TURN RESET

Technopolymer body, round front element.

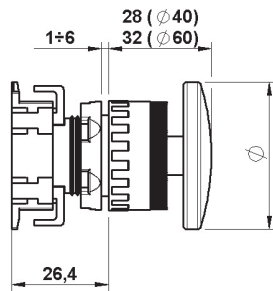

COLOR	CODE	REF.
RED	1003A00052	RT065R - 40 MUSHROOM (DIAM. 40mm)
RED	1003A00057	RT065R - 60 MUSHROOM (DIAM. 60mm)

## 3 POSITIONS LEVER

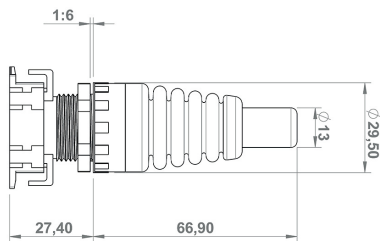

TYPE	CODE	Function
3 POSITIONS FIXED	1003A00084	
3 POSITIONS RETURN	1003A00085	

## ELECTRICAL SWITCH\*

For panel actuator.

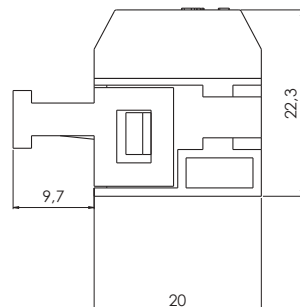

### TECHNICAL DATA

**Isolation Voltage** Vi 660

**Termichal Current** Ith 12A

**Protection** IP 20

**Category of use** AC 15

COLOR	CODE	REF.
RED	1003A00050	CONTATTO NC
GREEN	1003A00051	CONTATTO NO

\* Suitable for line 100 only.

# LINE 100 M5-Ø4 | VALVES FOR PANEL MOUNTING ACTUATORS



## MICROVALVES FOR PANEL MOUNTING ACTUATORS REAR PORTS

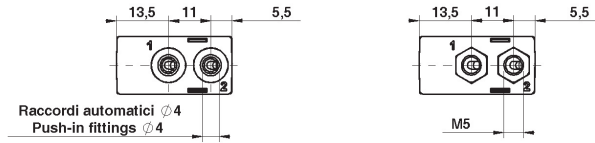

	CODE	REFERENCES
	<b>1000412005</b> <b>1000492005</b>	<b>MV M5 15 2 PB ML NC P</b> <b>MV AU4 15 2 PB ML NC P</b>
	<b>1000413009</b> <b>1000493009</b>	<b>MV M5 15 3 PB ML NC P</b> <b>MV AU4 15 3 PB ML NC P</b>
	<b>1000413010</b> <b>1000493010</b>	<b>MV M5 15 3 PB ML NO P</b> <b>MV AU4 15 3 PB ML NO P</b>

### TECHNICAL DATA

Weight 0,030 kg

NB: Possible combinations  
 5/2 = 3/2 NC + 3/2 NO  
 5/3 Open center = 3/2 NC + 3/2 NC

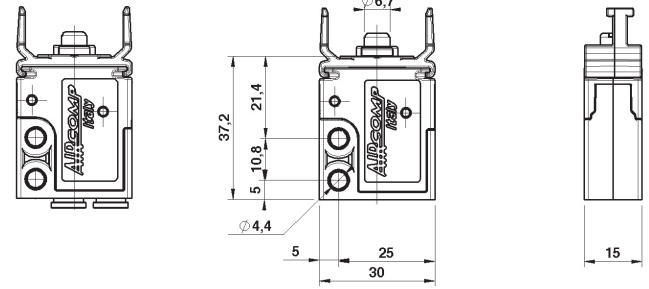

AU4 VERSION

M5 VERSION

### POSSIBLE COMBINATIONS

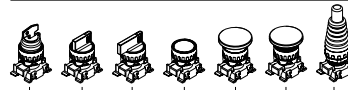

For pannel actuators see Page 2.87

## MICROVALVES FOR PANEL MOUNTING ACTUATORS WITH SIDE PORTS



	CODE	REFERENCES
	<b>1000412105</b> <b>1000492105</b>	<b>MV ML5 15 2 PB ML NC P</b> <b>MV AL4 15 2 PB ML NC P</b>
	<b>1000413109</b> <b>1000493109</b>	<b>MV ML5 15 3 PB ML NC P</b> <b>MV AL4 15 3 PB ML NC P</b>
	<b>1000413110</b> <b>1000493110</b>	<b>MV ML5 15 3 PB ML NO P</b> <b>MV AL4 15 3 PB ML NO P</b>

### TECHNICAL DATA

Weight 0,030 kg

NB: Possible combinations  
 5/2 = 3/2 NC + 3/2 NO  
 5/3 Open center = 3/2 NC + 3/2 NC

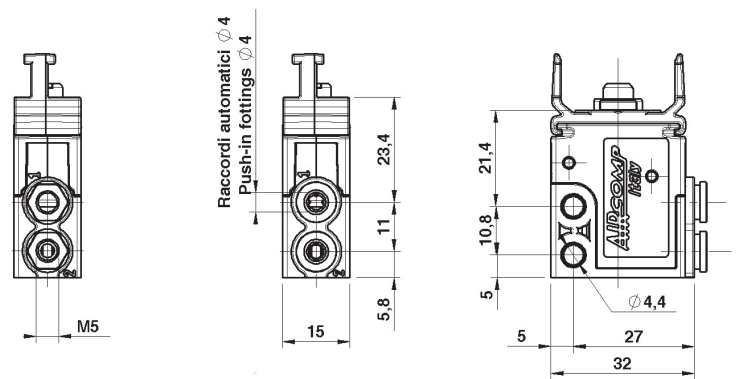

AU4 VERSION

M5 VERSION

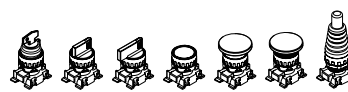

For pannel actuators see Page 2.87

AIR PREPARATION

VALVES

CYLINDERS

FITTINGS

WATER PREPARATION

# LINE 120-1/8" | VALVES FOR PANEL MOUNTING ACTUATORS

**FLUIDTECHNIK**  
bohemia

## 3/2 VALVES FOR PANEL MOUNTING ACTUATORS



	CODE	REFERENCES
	1202523009	ME 1/8" 22 3 PB PM NC P
	1202523010	ME 1/8" 22 3 PB PM NO P

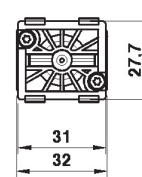
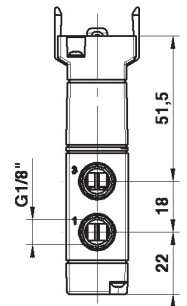
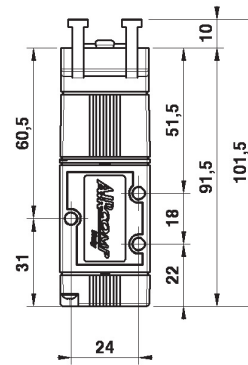
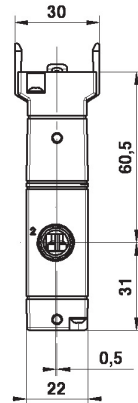

### TECHNICAL DATA

**Working pressure** 1÷10 Bar (0,1÷1,00 MPa)

**Weight** 0,078 kg

### AVAILABLE CONFIGURATIONS (\*)

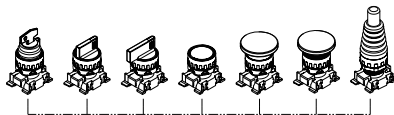

## 5/2 VALVES FOR PANEL MOUNTING ACTUATORS



	CODE	REFERENCES
	1202525005	ME 1/8" 22 5 PB PM OO P

### TECHNICAL DATA

**Working pressure** 1÷10 Bar (0,01÷1,00 MPa)

**Weight** 0,085 kg

### AVAILABLE CONFIGURATIONS (\*)

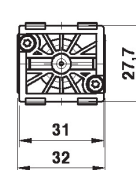
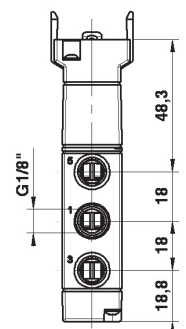
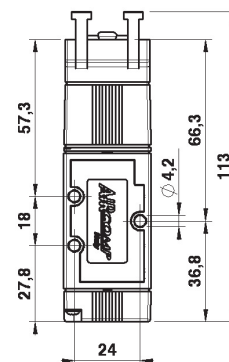
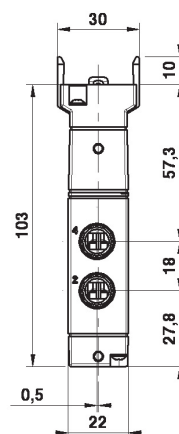
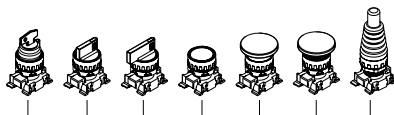

# LINE 125-1/4" | VALVES FOR PANEL MOUNTING ACTUATORS

## 3/2 VALVES FOR PANEL MOUNTING ACTUATORS

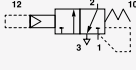
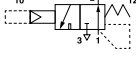

CODE	REFERENCES
 1252533009	MER 1/4" 22 3 PB PM NC P
 1252533010	MER 1/4" 22 3 PB PM NO P

### TECHNICAL DATA

**Working pressure** 1÷10 bar (0,10÷1,00 Mpa)

**Weight** 0,087 kg

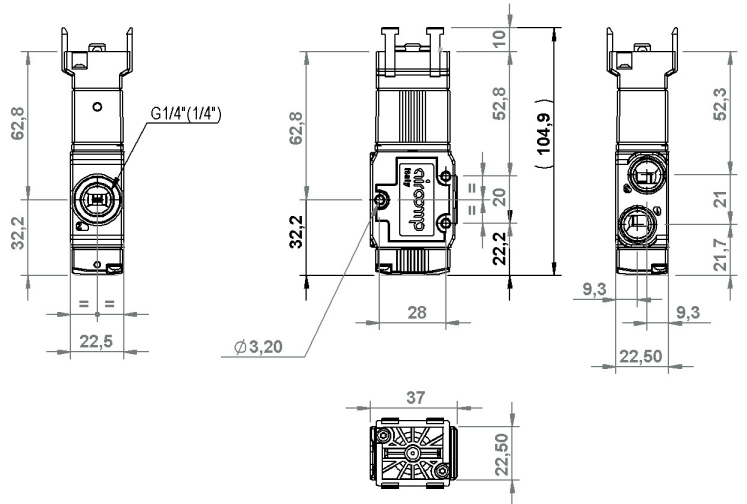

## VALVES 5/2 PRE-SET FOR PANEL MOUNTING ACTUATORS

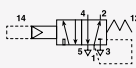

CODE	REFERENCES
 1252535005	MER 1/4" 22 5 PB PM OO P

### TECHNICAL DATA

**Working pressure** 1÷10 Bar (0,10÷1,00 MPa)

**Weight** 0,105 kg

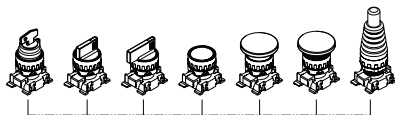
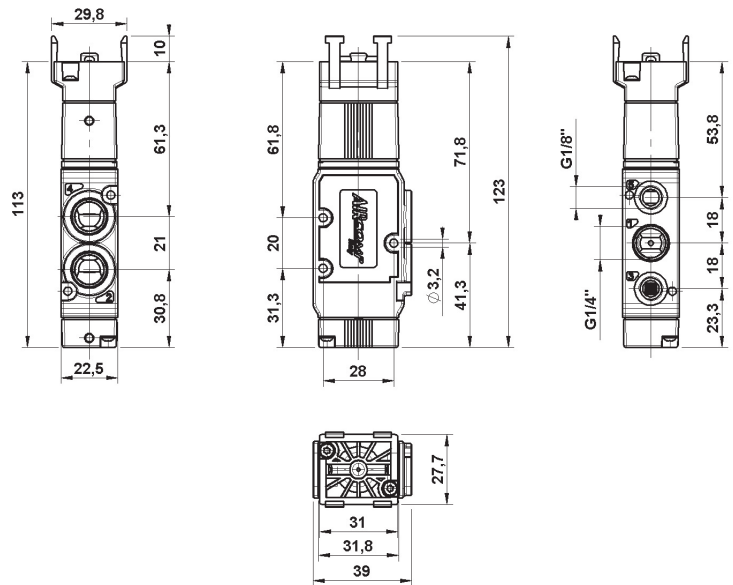

AIR PREPARATION

VALVES

CYLINDERS

FITTINGS

WATER PREPARATION



# LINE 127-1/4" | VALVES FOR PANEL MOUNTING ACTUATORS



## 3/2 VALVES FOR PANEL MOUNTING ACTUATORS



CODE	REFERENCES
1272533009	MER 1/4" 22 3 PB PM NC M
1272533010	MER 1/4" 22 3 PB PM NO M

### TECHNICAL DATA

**Working pressure** 1+10 Bar (0,10+1,00 MPa)  
**Weight** 0,138 kg

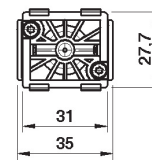
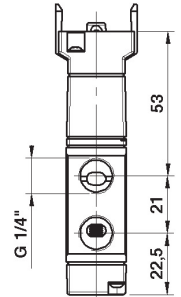
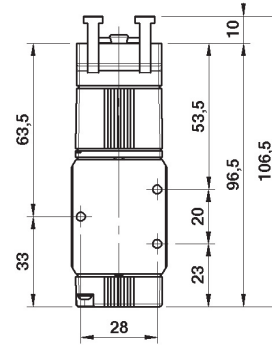
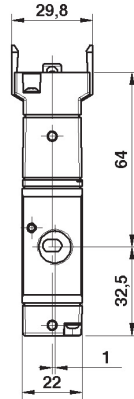

## 5/2 VALVES FOR PANEL MOUNTING ACTUATORS



CODE	REFERENCES
1272535002	MER 1/4" 22 5 PB PM OO M

### TECHNICAL DATA

**Working pressure** 1+10 Bar (0,10+1,00 MPa)  
**Thrust force** (a 6 Bar) 4,5 N  
**Weight** 0,146 kg

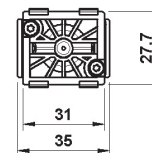
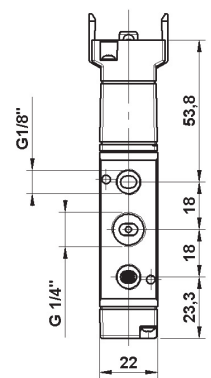
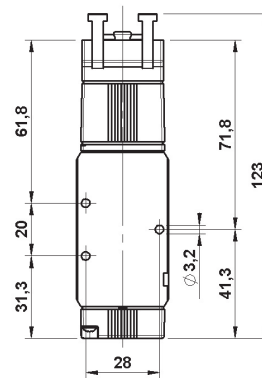
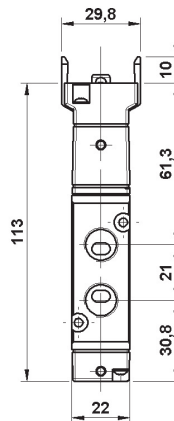

### AVAILABLE CONFIGURATIONS (\*)

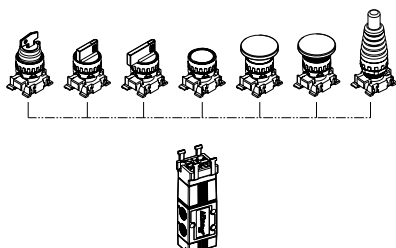

AIR PREPARATION

VALVES

CYLINDERS

FITTINGS

WATER PREPARATION

# LINE 100-120-125-127 | PANEL ACTUATORS

**FLUIDTECHNIK**<sup>®</sup>  
bohemia

## PUSH-BUTTON PROTECTION



COLOR	CODE	CONF.
TRANSPARENT	1003A00080	10 pieces

## MUSHROOM PROTECTION



COLOR	CODE	CONF.
YELLOW	1003A00086	5 pieces

## SELECTOR PROTECTION



COLOR	CODE	CONF.
GREY	1003A 00087	5 pieces

## PLASTIC PLATE EMERGENCY-STOP



COLOR	CODE	Ø	CONF.
YELLOW	1003A00088	40mm	10 pieces
YELLOW	1003A00089	60mm	10 pieces

## PLATE FOR SELECTOR (NEUTRAL)



COLOR	CODE	CONF.
BLACK	1003A00090	10 pieces

## PANEL PLUG



COLOR	CODE	CONF.
GREY	1003A00091	10 pieces

AIR PREPARATION

VALVES

CYLINDERS

FITTINGS

WATER PREPARATION